

# Instructions for visiting the tower with observation deck



## - round trip without oncoming traffic -

- Persons experiencing symptoms of acute respiratory distress are not permitted inside the tower with observation deck.
- There are 52 steps leading up to the lift hall.

- The **only way up** to the observation deck is **by elevator**.  
**Only one person or multiple members of the same household** are permitted on the lift at a time.

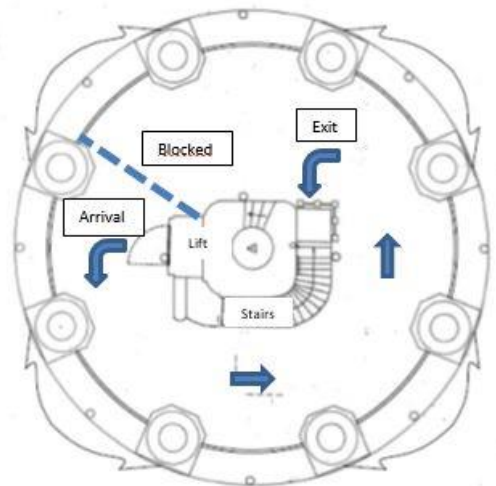

Path along the observation deck

- All movement on the observation deck flows in one direction only (see sketch).

Please turn over

- The **only way down** from the observation deck is the **452 steps**. This route will lead you through nine tower floors and past the old clockwork (clock floor) and the church bells.
- **The tower floor 9** is located **directly under the platform**. Here you will find a **contact person**, seatings, background music, a short Hamburg film and you can choose a small non-alcoholic drink (hot or cold).
- Hand sanitiser is available before you take the lift and once you reach the ground again. **Hand disinfection is mandatory before ascending**.
- Please maintain a **distance of at least 1.50 metres** from others at all times.
- Use a **face cover** if at all possible. It is **mandatory in the elevator**.
- Please cough and sneeze into a tissue or your elbow and refrain from touching your eyes, nose or mouth.
- There are **no toilets** inside the tower.
- For emergencies during your visit to the tower, you can reach the **cash register at the entrance gate 2** on **+49 (0)40 3767 8140**.